

Drainage Summary:	
Detention Pond Outfall: 12" PVC Outfall	Q ₂₅ =4.66 CFS Q ₅₀ =5.45 CFS Q ₁₀₀ =6.75 CFS Q _{max} =8.67 CFS
Driveway Culvert: 24" RCP	V ₂₅ =6.04 FT/S V ₅₀ =7.01 FT/S V ₁₀₀ =7.37 FT/S V _{max} =10.91 FT/S
	Q ₂₅ =11.16 CFS Q ₅₀ =12.64 CFS Q ₁₀₀ =13.19 CFS Q _{max} =18.24 CFS
	V ₂₅ =4.15 FT/S V ₅₀ =4.59 FT/S V ₁₀₀ =4.75 FT/S V _{max} =6.21 FT/S

- Traffic Control Plan Notes:**
- TXDOT traffic control plan TCP (2-1) and TCP (2-4a), as needed, shall be followed for this project.
 - The traffic control plan shall be in accordance with the Texas Manual Uniform Traffic Control Devices (TMUTCD), Part VI, Construction.
 - Prior to implementing traffic control plan, contractor must provide advance notice to the following:
 - COCS Public Works Department
 - COCS Emergency Operations Center
 - COCS Police Dispatch
 - COCS Fire Dispatch
 - TAMU Bus Transit System
 - COCS ISD
 - COCS Traffic Engineer
 - All signage to be mounted 24" clear from travel lane and 7' clear height from top of curb.

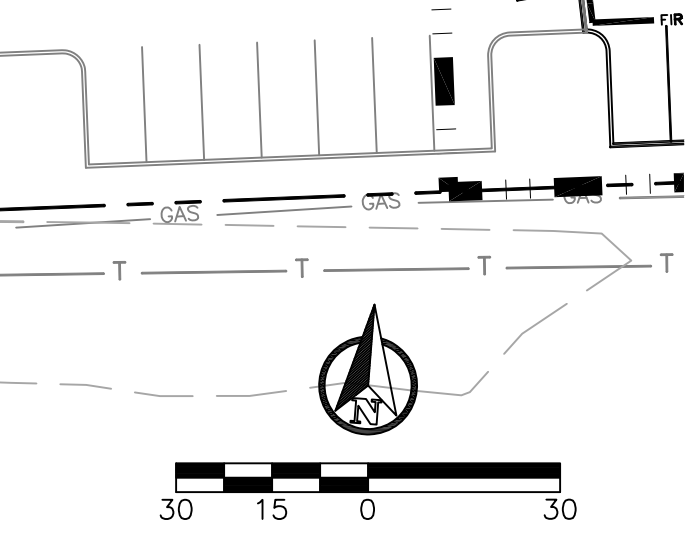

TxDOT Driveway & Pavement Plan

- General Notes:**
- Refer to Final Plat for all lot dimensions and bearings.
 - All dimension are to back of curb or edge of pavement, unless otherwise noted.
 - Materials and methods for pavement markings shall conform to TxDOT Standard Specifications for Construction of Highways, Streets, and Bridges (current edition).
 - Removal of existing pavement markings shall comply with TxDOT Specifications Item 677 "Eliminating Existing Pavement Marking and Marker" (current edition).
 - It is the intent of these plans to comply with all TxDOT guidelines, specifications, & details.

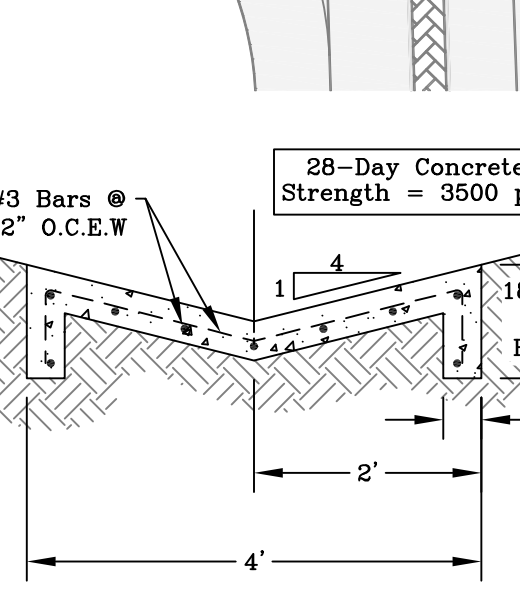

Typical Drainage Flume Cross-Section
N.T.S.

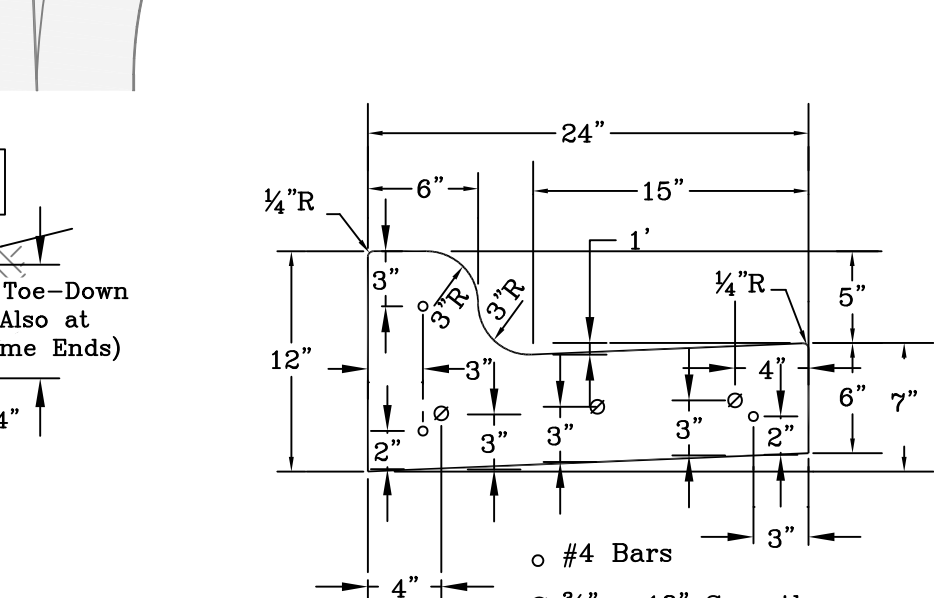

Driveway Raised Curb Detail
N.T.S.

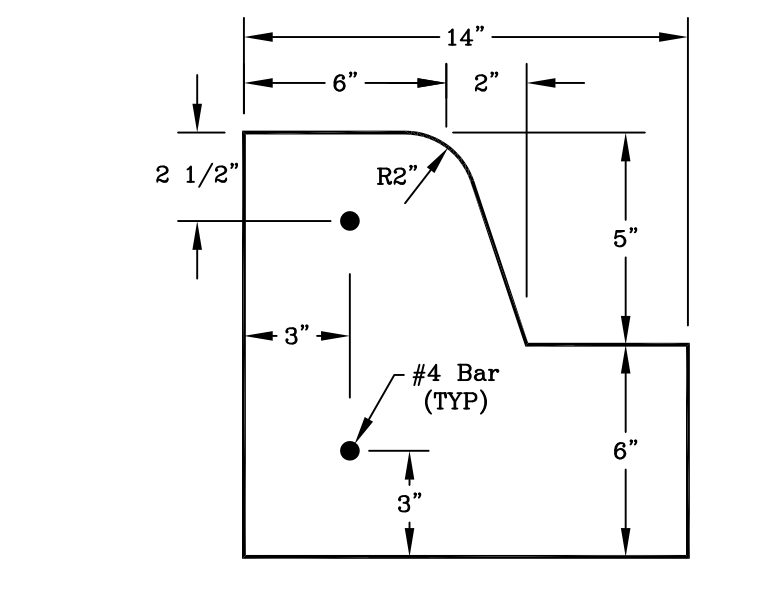

Type II - 5" Height Curb w/ Modified Gutter Detail
N.T.S.

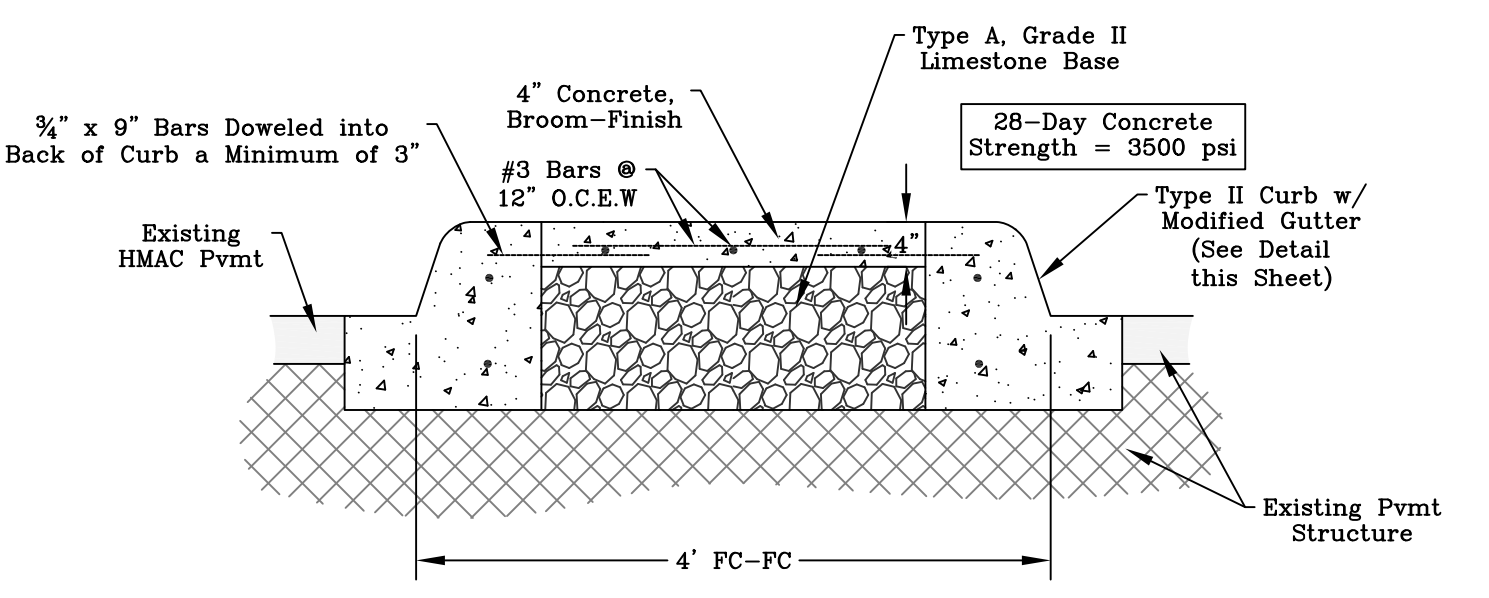

Typical Median Cross-Section
N.T.S.

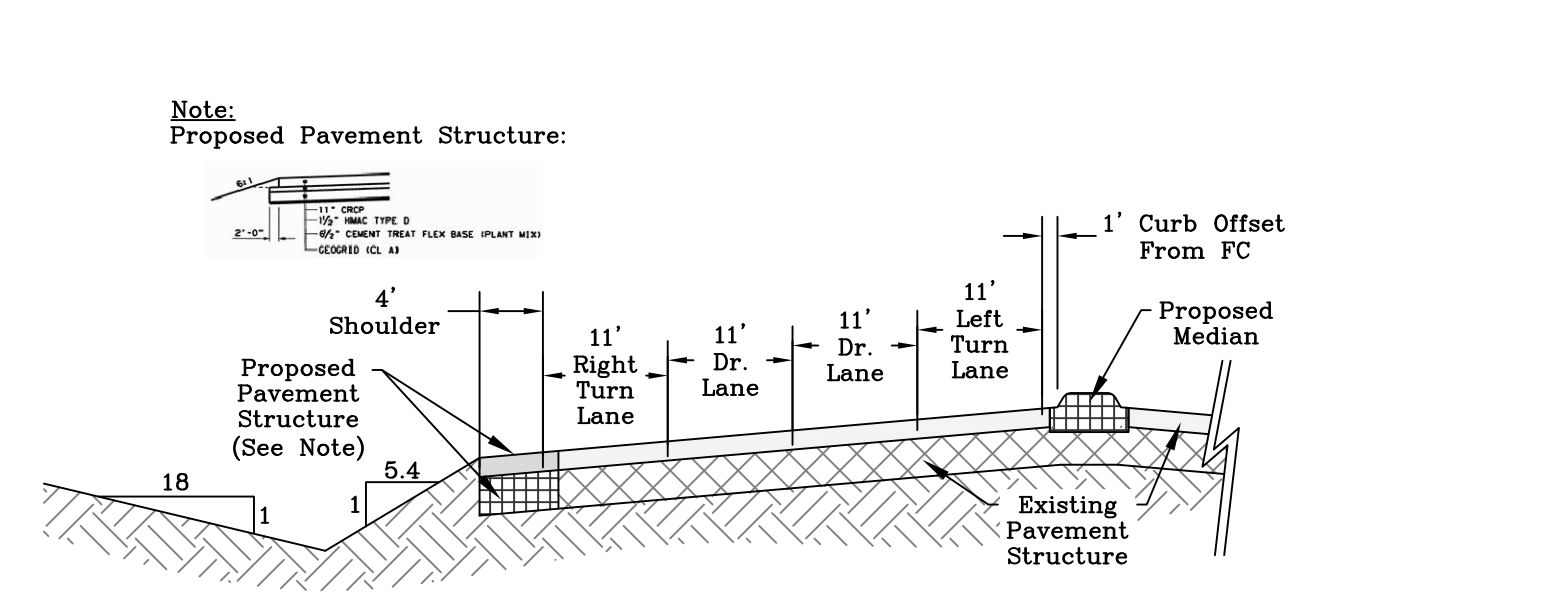

Typical FM 2818 Cross-Section
N.T.S.

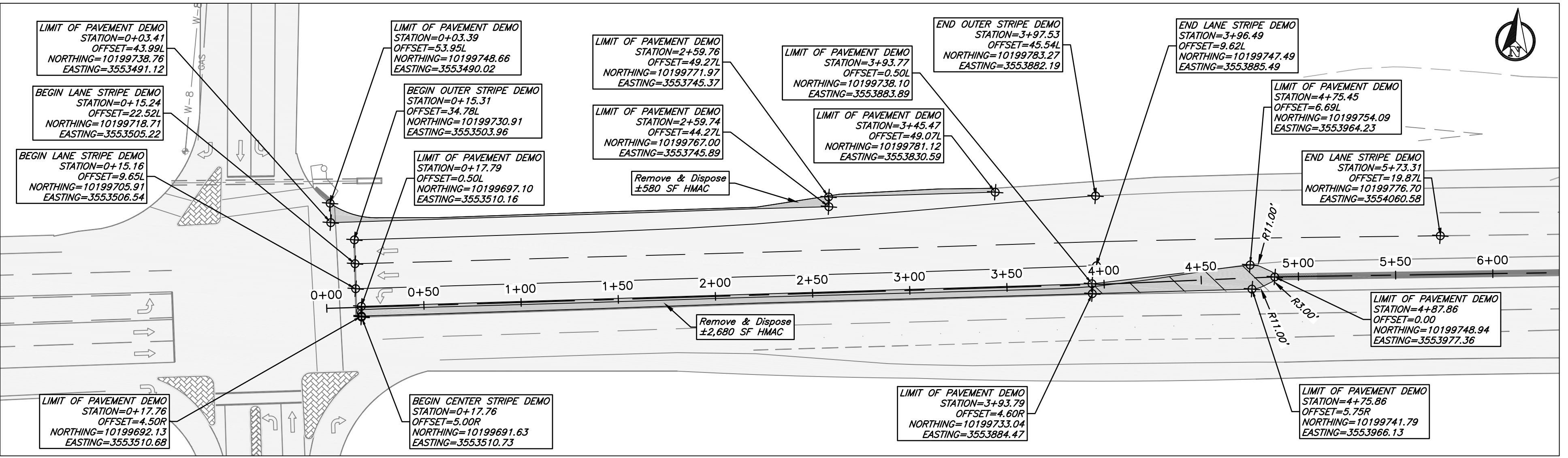

Demolition Detail
Scale 1:40

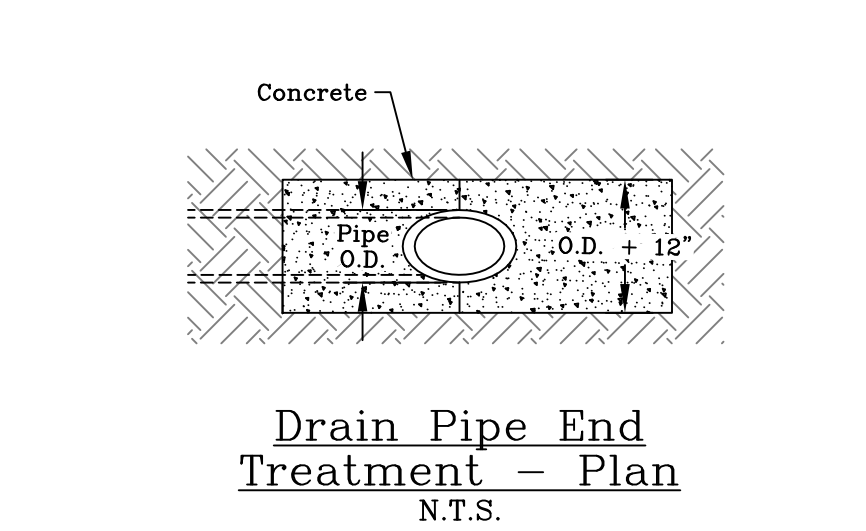

Drain Pipe End Treatment - Plan
N.T.S.

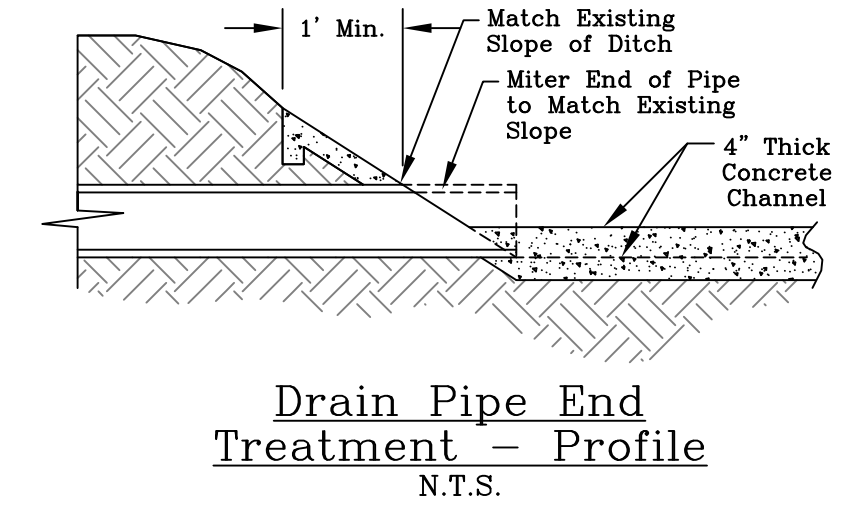

Drain Pipe End Treatment - Profile
N.T.S.

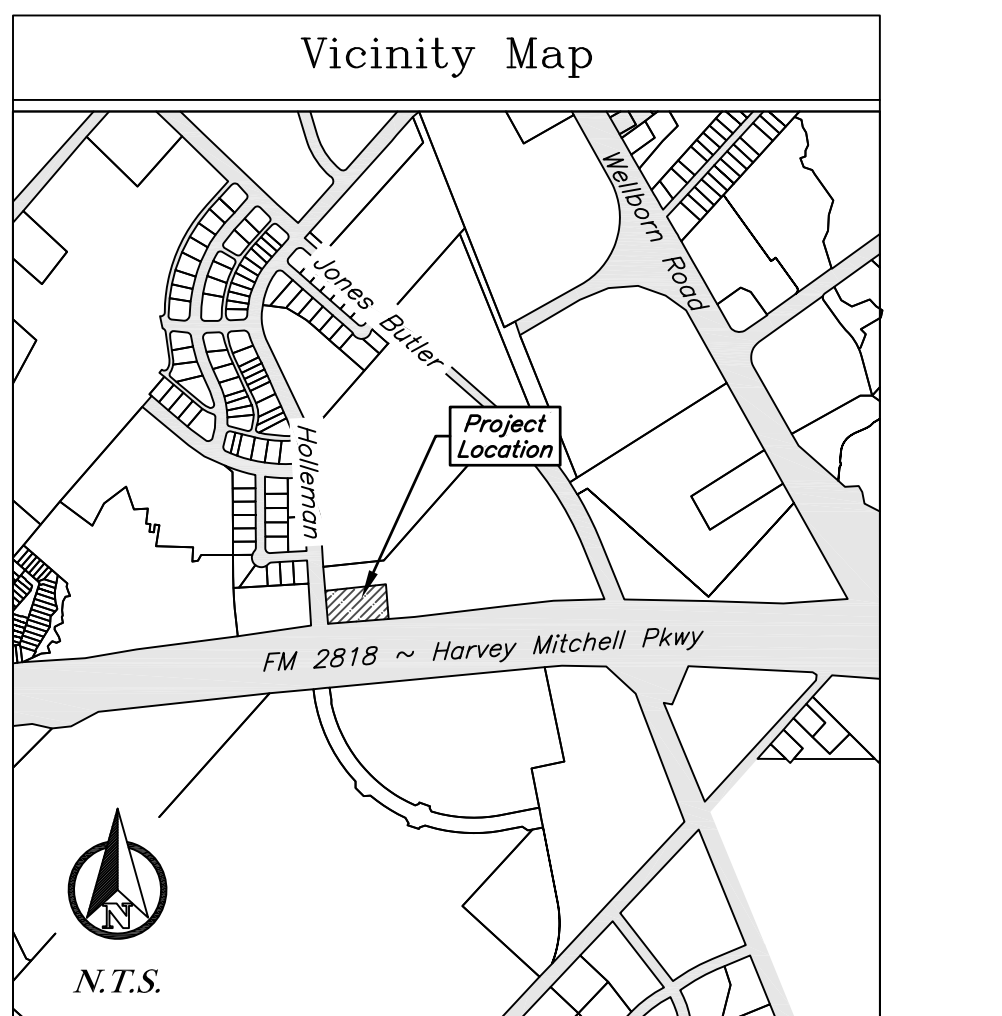

Vicinity Map
N.T.S.

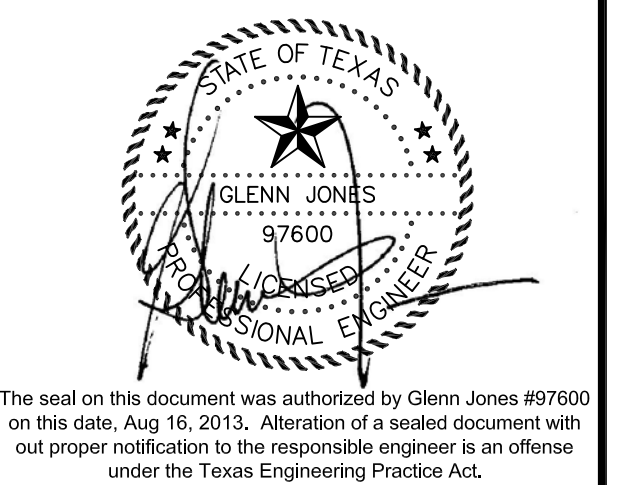

The seal on this document was authorized by Glenn Jones #97600 on this date, Aug 16, 2013. Alteration of a sealed document without proper notification to the responsible engineer is an offense under the Texas Engineering Practice Act.

No.	Revision/Issue	Date

Firm Name and Address:

J4 Engineering
 PO Box 5192 - Bryan, Texas - 77805
 979-739-0567 www.J4Engineering.com
 Firm # 9951

Project Name and Address:

Holleman Exxon
 2041 Holleman Drive
 Lot 2, Block 1 Lakeridge
 Subdivision - 1.25 AC
 College Station, Brazos County, Texas

Date: Aug 2013
 Scale: As Noted
 Sheet: C7

J4 Engineering 8/16/13 Holleman Exxon.dwg J4E Project # 12-006